

NORIS STABIL UNI HSSE
Katalog-Nr. 6560 / 7560

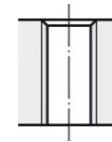

4xD

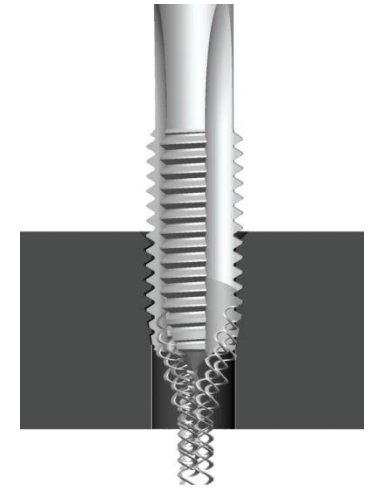
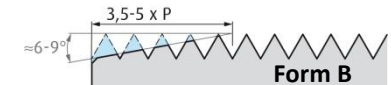

A	$\leq 1100\text{N/mm}^2$	6-15 m/min	Emulsion
R	$\leq 850\text{N/mm}^2$	6-8 m/min	Emulsion / Öl

NORIS STABIL UNI HSSE

Katalog-Nr. 6560 / 7560

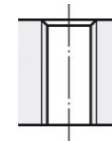
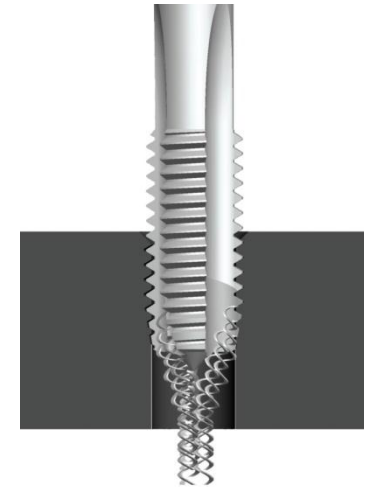

4xD

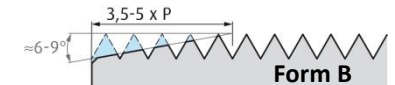

A	$\leq 1100\text{N/mm}^2$	8-18 m/min	Emulsion
R	$\leq 1100\text{N/mm}^2$	6-10 m/min	Emulsion / Öl
F	GJL, GJS, GJV, GTW, GTS	10-20 m/min	Emulsion
N	G-ALMg, GD-ALSi, CuZn, CuAl	6-15 m/min	Emulsion

NORIS STABIL UNI HSSE

Katalog-Nr. 6560 / 7560



TICN Beschichtung

Schaft h9

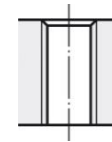
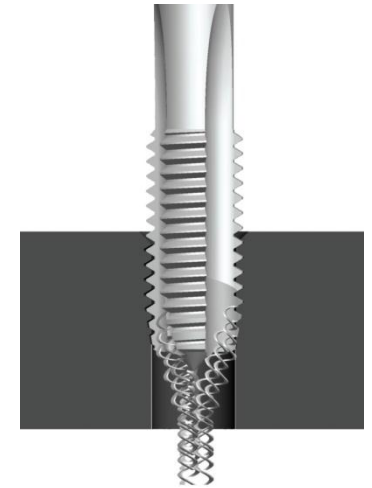

4xD

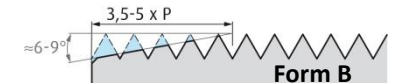

A	≤1100N/mm ²	8-18 m/min	Emulsion
R	≤ 1100N/mm ²	6-10 m/min	Emulsion / Öl
F	GJL, GJS, GJV, GTW, GTS	10-20 m/min	Emulsion
N	G-AlMg, GD-AlSi, CuZn, CuAl	6-15 m/min	Emulsion