

# NORIS STABIL ST AZ HSSE

## Katalog-Nr. 6090 / 7090



blank

Schaft h9

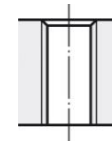
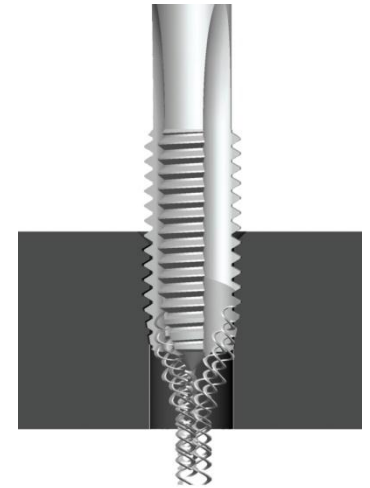

4xD

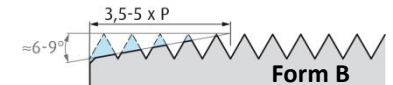

**AZ**

Ausgesetzte Zähne verringern die Reibung. Die Kühlschmierstoffzufuhr wird verbessert.

<b>A</b>	≤850N/mm <sup>2</sup>	8-15 m/min	Emulsion
<b>F</b>	GTW, GTS	8-12 m/min	Emulsion
<b>N</b>	langsp.CuZn	15-20 m/min	Emulsion